

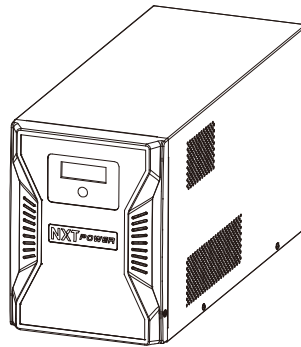

Integrity Pro Medical / Non-Medical User Manual

600 / 800 / 1100 / 1440 VA

**NPTU 600-L-N
NPTU 800-L-N
NPTU 600-LM-N
NPTU 800-LM-N**



**NPTU 1100-L-N
NPTU 1500-L-N
NPTU 1100-LM-N
NPTU 1500-LM-N
NPTU 1100-L-i
NPTU 1500-L-i
NPTU 1100-LM-i
NPTU 1500-LM-i**

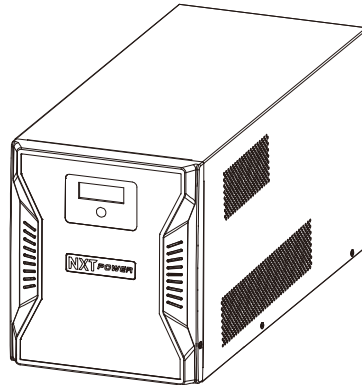

Table of Contents

1. Safety Instructions and Storage / Battery Care	1
2. UPS System Block Diagram.....	1
3. Front Panel Display	1
4. Product Features.....	2
5. Button Function	2
6. Installation and Start up	3
7. Alarms and Status Icons	3
8. Specifications.....	3
9. Battery Replacement Procedure	4
10. Warrenty information.....	5

1. Safety Instructions and Storage/ Battery Care

- SAVE THESE INSTRUCTIONS.** - This manual contains important instructions that should be followed during installation and maintenance of the UPS and batteries.
- Read the instructions carefully to become familiar with the equipment before starting the installation process. Notify the carrier and dealer if there is any damage to the unit. Do not install if unit has signs of physical damage.
- Adhere to all national and local electrical codes.
 - This UPS is intended for indoor use only.
 - Do not operate this UPS in direct sunlight, in contact with liquids, or where there is excessive dust or humidity.
 - Be sure the air vents on the UPS are not blocked. Allow adequate space for proper ventilation. Keep rear panel a minimum of 8 inches (20cm) from any obstructions.
 - For a UPS with a factory installed power cord, connect the UPS power cable directly to a wall outlet. Do not use surge protectors or extension cords. Use only the power cord supplied with the UPS.
 - The battery typically lasts for three to five years. Environmental factors will impact battery life. Elevated ambient temperatures, poor quality utility power, and frequent short duration discharges will shorten battery life.
 - The equipment and batteries are heavy. Remove the batteries before lifting the UPS and practice safe lifting techniques adequate for the weight of the equipment.
 - Before installing or servicing the equipment check that the Disconnecting from the AC mains and load. The UPS contains internal batteries and may present a shock hazard even when disconnected from the branch circuit (mains).
 - Doing wiring, maintenance service and batteries replacement should be performed or supervised by personnel knowledgeable about batteries and the required precautions.
 - When replacing batteries, replace with the same type and number of batteries or battery packs.
 - This UPS is intended for patient vicinity use only. Do not use this UPS for any life support applications or critical support.
 - CAUTION: Do not dispose of batteries into fire. The batteries may explode.
 - CAUTION: Do not open or mutilate batteries. Released electrolyte is harmful to the skin, eyes, and may be toxic.
 - CAUTION: A battery can present a risk of electrical shock and high short-circuit current through conductive materials and could cause severe burns. The following precautions should be observed when working on batteries:
Before installing or replacing the batteries, remove jewelry such as wristwatches and rings, or other metal objects. When working on batteries should wear rubber gloves and boots. Also, must use tools with insulated handles. Do not lay tools or metal parts on top of batteries.
Remove battery grounds during installation and maintenance to reduce likelihood of shock. Remove the connection from ground if any part of the battery is determined to be grounded.

2. UPS System Block Diagram

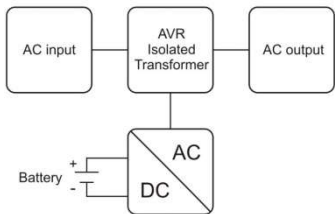

3. Front Panel Display

LCD	Status
	1. AC mains mode
	2. Battery/inverter mode
	3. Automatic Voltage Regulation (Buck or Boost)
	4. Battery capacity
	5. Load capacity
	6. UPS status
	7. Power ON/OFF button

4. Product Features

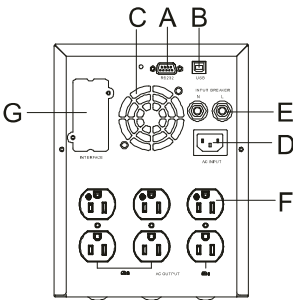

NPTU600-L-N/ PTU600-LM-N
NPTU800-L-N / PTU800-LM-N

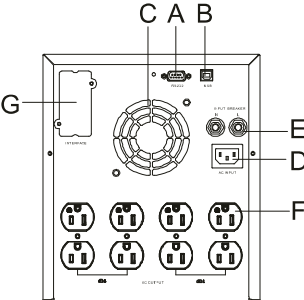



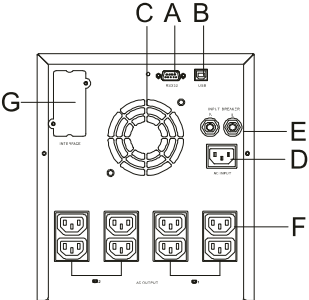

NPTU1100-L-N / NPTU1100-LM-N
NPTU1500-L-N / NPTU1500-LM-N



NPTU1100-L-i/ PTU1100-LM-i
NPTU1500-L-i/ PTU1500-LM-i

A: RS-232	E: Input Breaker
B: USB port	F: AC Outlets (Program relay, PRY)
C: Fan / Ventilation hole	G: Intelligent Slot
D: AC Inlet	

5. Button Function

Status	Action Description	LCD Display
Power ON	Press the on/off button for 5~8 seconds, release the button when the alarm sounds The UPS will now turn on.	 The (2) icons highlighted in red will flash
Power OFF	Press the on/off button for 5~8 seconds, release the button when the alarm sounds The UPS will now turn off.	 The (2) icons highlighted in red will flash
Alarm silence	When the UPS is in an abnormal state, the alarm will sound. Press on/off button for ½ second (Do not hold the button longer that 1 second). This will silence the alarm	
Self-Test	(With the UPS in AC mains operation) press the on/off button for 1~2 seconds, release the button when the alarm sounds a short beep. The UPS will perform a self-test.	 The icon highlighted in red will flash
Outlet Status	(With the UPS ON) Press the on/off button two times in 5 seconds to enter outlet status mode. With no actions for 5 seconds, the UPS will exit outlet status mode.	 Group 1 Group 2 The highlighted icon in the above figure shows: Group 1 (10n/10F): Output at 1 Group 2 (20n/20F): Output at 2 Please use software tool for outlet status setting

To clear the error icon	Hold down the on/off button for 5~8 seconds, release the button when the alarm beeps. The error icon will be removed.	
-------------------------	---	--

6. Installation and Power On

1. Installation:

- Please read **Section 1, Safety Instructions and Storage/ Battery Care** before installing.

2. Connect equipment to the UPS. Avoid using extension cords.

- Do NOT connect printers, heaters, or copiers to the UPS.
- During a power outage or other AC problems, the outlets receive power for a limited time from the UPS.

3. Press the ON/OFF button for 5~8 seconds to turn the unit on.

- The UPS should charge the battery for at least 6 hours to ensure sufficient runtime.
- Press ON/OFF button in 5~8 seconds. The alarm sounds to confirms that the UPS is on and provide power to outlets.

4. Cold start the UPS.



- Use cold start feature to supply power to connected equipment from the UPS batteries when there is no utility power. To turn on the UPS see step 3 above.

5. Connect and install management software.

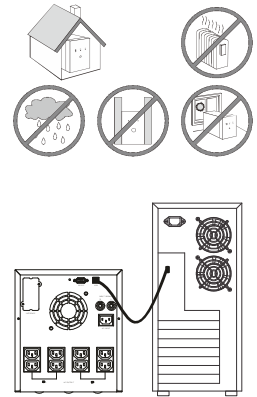
- UPS is provided with management software for unattended operating system shutdown, UPS monitoring, and UPS settings.



7. Audible alarms and Status Icons

If the UPS...	Possible cause...
In Battery Mode: Alarm sounds every 2 seconds. (alarm for 0.5 second and stops for 1.5 seconds)	UPS is running on battery. You should consider saving any work in progress.
a. Low Battery: alarm sounds every 0.2 seconds b. Low Battery power off: Continuous alarm	Low battery condition and battery run-time is very low. Promptly save any work in progress, exit all open applications, and shut down the operating system.
Continuous tone with  flashing.	UPS is overloaded.
Continuous tone with  illuminated. a. Press ON/OFF button one time to mute the alarm. b. Continuous alarm will sound until battery runs low. (<11Vdc each battery)	<i>Err 01</i> : Fan fault detected <i>Err 02</i> : Inverter short <i>Err 03</i> : Inverter over voltage <i>Err 05</i> : Transformer over temperature
Battery Replacement Alarm: alarms every 4 seconds (alarms for 1 second and stops for 3 seconds)	The battery is near the end of useful life or damaged. Replace battery

8. Specifications

		Low Voltage Models (Domestic)				High Voltage Models (International)	
Model		NPTU600-L-N	NPTU800-L-N	NPTU1100-L-N	NPTU1500-L-N	NPTU1100-L-I	NPTU1500-L-I
Medical Model		NPTU600-LM-N	NPTU800-LM-N	NPTU1100-LM-N	NPTU1500-LM-N	NPTU1100-LM-I	NPTU1500-LM-I
Input	Voltage range	100V _{AC} : 80-120 V _{AC} 120V _{AC} : 96-144 V _{AC}				208V _{AC} : 167-249 V _{AC} 230V _{AC} : 184-276 V _{AC} 240V _{AC} : 192-288 V _{AC}	
	Connection	IEC320 C-14					
	Frequency Range	50 / 60 Hz(Auto sensing)					
Output	UPS Capacity (total)	600VA/540W	800VA/720W	1100VA/990W	1440VA/1296W	1100VA/990W	1440VA/1296W
	Rated Voltage	100VAC / 120VAC				208VAC / 230VAC / 240VAC	
	Transfer time	Typical 2-6 ms, 12ms max.					
	Waveform	Pure Sine Wave					

Battery	Type & Number (lead-acid battery)	12V/7Ah x 2	12V/9Ah x 2	12V/7Ah x 4	12V/9Ah x 4	12V/7Ah x 4	12V/9Ah x 4
Physical	Dimension (D x W x H)	17.7 x 7 x 9.3 inch 450 x 180 x 236 mm		20.7 x 8.7 x 10 inch 525 x 220 x 254 mm			
	Net Weight	46.1 lb 20.9 kg	48.2 lb 21.9 kg	82.9 lb 37.6 kg	87.3 lb 39.6 kg	84 lb 38.1 kg	88.4 lb 40.1 kg
	Packaging Dimension (D x W x H)	23 x 12.4 x 15.8 inch 584 x 314 x 401 mm		26 x 14 x 16.5 inch 659 x 354 x 419 mm			
	Gross Weight	52.7 lb 23.9 kg	54.9 lb 24.9 kg	88.8 lb 40.3 kg	93.3 lb 42.3 kg	90 lb 40.8 kg	94.4 lb 42.8 kg
Environment	Operating temperature & Humidity	0-95 % RH @ 0-40°C (non-condensing)					
	Noise level	AC Line mode: 0-70% load < 43dB AC Line mode: 70-100% load < 50dB Backup mode: 0-100% load < 60dB					

9. Battery Replacement Procedure

Qualified Service Personnel Only

PLEASE READ ALL OF THE CAUTIONS AND THE WARNINGS BEFORE ATTEMPTING TO REPLACE THE BATTERY MODULE

Warning: Lead-acid battery could be drained and damaged by long-term self-discharge naturally without maintenance.

1100VA / 1440VA 48Vdc

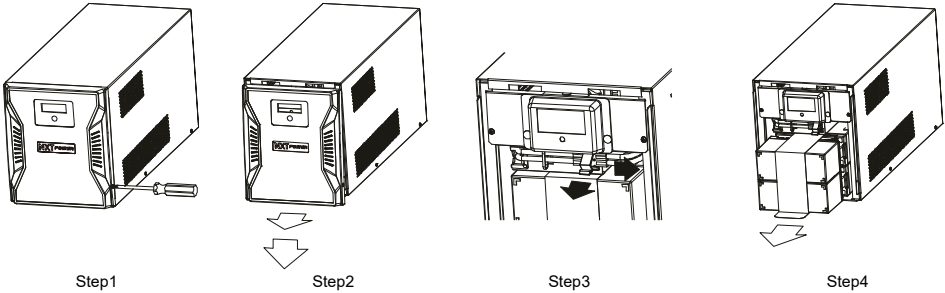

600VA / 800VA 24Vdc

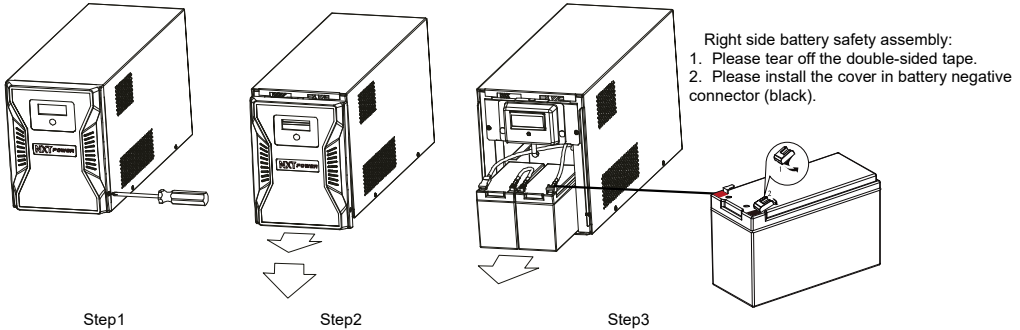

Recycling the Used battery

Contact your local recycling or hazardous waste center for information on proper disposal of the used battery.

10. Warranty Information

Integrity Pro Series Products (hereafter referred to as "Product") are warranted to be free from defects in material and workmanship for **thirty six (36) months** from date of shipment from NXT POWER, on the chassis & electronic components and **thirty six (36) months** from date of shipment from NXT POWER on the batteries. This warranty is limited to NXT POWER Product Exchange service. See full Warranty statement for additional limitations & exclusions.

24 Hour Technical Support Call Center:

Phone: (877) NXT-POWER or (877) 698-7697

Email: service@nxtpower.com



192321572001003